

Spa Owner's Manual

DreamMaker SPAS
Live the dream

www.dreammakerspas.com

This Manual Contains
**IMPORTANT SAFETY
INSTRUCTIONS**

**READ AND FOLLOW ALL INSTRUCTIONS
“SAVE THESE INSTRUCTIONS”**



OWNER'S INFORMATION

DEALER

Company

Address

Phone

E-mail

INSTALLER

Company

Address

Phone

Warranty Turned In / Date

SPA

Model

Series

Serial Number (see next page for location)

Color

Date of Delivery

We appreciate your business and our sincere desire is that you receive years of pleasure and therapy from your Dreammaker Spa. Please call your local Dreammaker Spa Dealer if you have any questions or problems. If they are unavailable, please feel free to call the Dreammaker Spas Customer Service Group at:

888.ROTO SPA (888.7686 772)

LOCATING THE SERIAL NUMBER

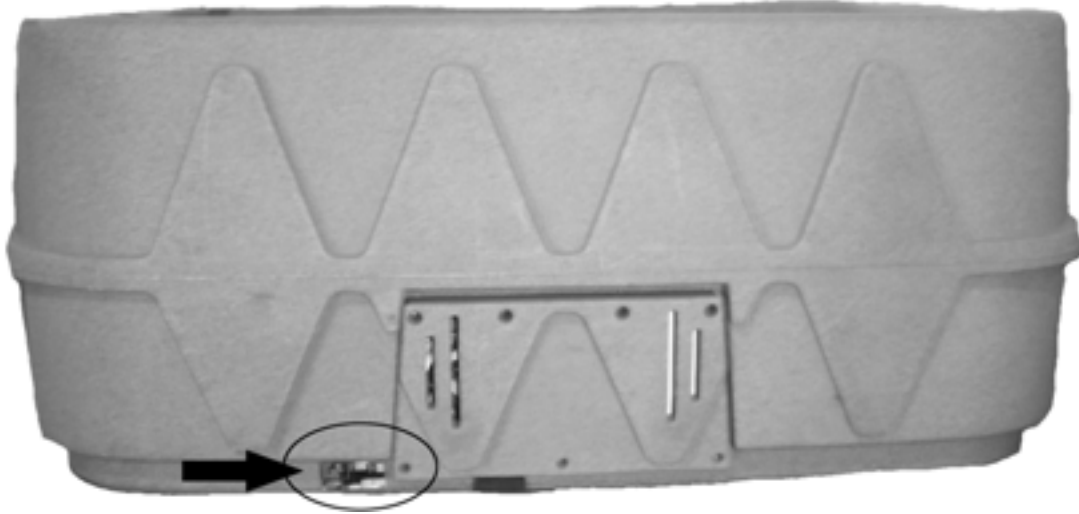

There is a black plate located to the right or left of the access door



SERIAL # _____

TABLE OF CONTENTS

IMPORTANT SPA SAFETY INSTRUCTIONS	1
Important Safety Precautions	2
Selecting A Location	3
Filling Your Spa	3
Locating Electrical Plug & Drain X-SPA and X-CAL Series	5
Jets & Air Adjustment for X-SPA and X-CAL Series	6
Surface Skim Filter Maintenance for X-SPA and X-CAL Series	6
Locating Electrical Plug & Drain	9
System Operation	10
Jets & Air Adjustment	11
Surface Skim Filter Maintenance	11
Spa Water Chemistry	12
Spa Maintenance Schedule	12
Freeze Protection	14
Cleaning The Spa	14
Most Frequently Asked Questions	15
Trouble Shooting Guide	16
Jet Wrench	17
Glossary of Terms	18

An important WARNING sign is packed with your Dream Maker Spa. This sign must be posted in a prominent place in close proximity to the spa installation site immediately upon completion of spa installation.

 <h1 style="margin: 0;">WARNING</h1>	
<p>DURING PREGNANCY, SOAKING IN HOT WATER MAY CAUSE DAMAGE TO THE FETUS. LIMIT USE TO 10 MINUTES AT A TIME.</p>	
<h2 style="margin: 0;">PREVENT DROWNING</h2> <p>SPA HEAT SPEEDS UP EFFECTS OF ALCOHOL, DRUGS, OR MEDICINE AND CAN CAUSE UNCONSCIOUSNESS. IMMEDIATELY LEAVE SPA IF UNCOMFORTABLE OR SLEEPY.</p>	<h2 style="margin: 0;">PREVENT CHILD DROWNING</h2> <p>WATER ATTRACTS CHILDREN. ALWAYS ATTACH A SPA COVER AFTER EACH USE.</p>
<small>PL601035 Rev A</small>	

THIS WARNING SIGN MUST BE POSTED BEFORE THE SPA IS USED!

THIS SPA IS FOR RESIDENTIAL USE ONLY!



IMPORTANT SAFETY INSTRUCTIONS

When installing and using this electrical equipment, basic safety precautions should always be followed, including the following:

1. READ AND FOLLOW ALL INSTRUCTIONS

2. Warning

To reduce the risk of injury, do not permit children to use this product unless they are closely supervised at all times.

3. A wire connector is provided on this unit to connect a minimum No. 8AWG (8.4mm) solid copper conductor between this unit and any metal equipment, metal enclosures of electrical equipment, metal water pipe, or conduit within 5 feet (1.5m) of the unit.

4. Danger Risk of Injury

(For cord and plug connected units)

A. Replace damaged cord immediately

B. Do not bury cord

C. Connect to a grounded, grounding type receptacle only.

4A. (For units with a G.F.C.I.)

WARNING - This product is provided with a Ground Fault Circuit Interrupter "G.F.C.I." on the end of the spa's power cord. This G.F.C.I. must be tested before each use. With the product operating depress the "test" button on the G.F.C.I. The spa should not operate. Depress the "Reset" button on the G.F.C.I. The product should now operate normally. If the spa fails to operate in this manner, there is a ground current flowing indicating a possible electric shock. Disconnect the power until the fault has been identified and corrected by a certified licensed electrician.

5. Warning

FOR PERMANENTLY INSTALLED UNITS - The electrical supply for this product must include a suitably rated switch or circuit breaker to open all ungrounded supply conductors to comply with Section 442-20 of the National Electric Code. ANSI / NFPA 70-1987. In addition, all 230 volt installations must be protected by a 230 volt Ground Fault Circuit Interrupter "G.F.C.I.". Any G.F.C.I. circuit breaker used in the house panel must read current returning through the neutral conductor. 230 volt 2 conductor G.F.C.I. circuit breakers will not operate correctly for your application.

6. Danger

Risk of Accidental Drowning. Extreme caution must be exercised to prevent unauthorized access by children. To avoid accidents, ensure that children cannot use this spa unless they are supervised at all times. For additional protection, select a cover which is classified by the Underwriters Laboratories Meeting ASTM F1346-91 requirements.

7. Danger

Risk of Injury. The suction fittings in this spa are sized to match the specific water flow created by the pump. Should the need arise to replace the suction fittings or the pump, be sure that the flow rates are compatible.

Never operate spa if suction fittings are broken or missing. Never replace a suction fitting with one less than the flow rate marked on the original suction fitting.

8. Danger

Risk of Electric Shock. Install at least 5 feet (1.5m) from all metal surfaces. As an alternative, a spa may be installed within 5 feet (1.5m) of metal surfaces if each metal surface is permanently connected by a minimum No. 8AWG (8.4mm) solid copper conductor to the wire connector on the terminal box that is provided for this purpose.

9. Danger

Risk of Electric Shock. Do not permit any electric appliance, such as light, telephone, radio, or television, within 5 feet (1.5m) of a spa.

10. Warning To reduce risk of injury:

- A. The water in a spa should never exceed 104°F (40°C). Water temperatures between 100°F (38°C) and 104°F (40°C) are considered safe for a healthy adult. Lower water temperatures are recommended for your children and when spa use exceeds 10 minutes.
- B. Since excessive water temperatures have high potential for fetal damage during the early months of pregnancy, pregnant or possibly pregnant women should limit spa water temperatures to 100°F (38°C).
- C. Before entering spa, the user should measure the water temperature with an accurate thermometer since the tolerance of water temperature-regulating devices vary.
- D. The use of alcohol, drugs, or medication before or during spa use may lead to unconsciousness with the possibility of drowning.
- E. Persons suffering from obesity or with a medical history of heart disease, low or high blood pressure, circulatory system problems, or diabetes should consult a physician before using a spa.
- F. Persons using medication should consult a physician before using a spa since some medication may induce drowsiness while other medication may affect heart rate, blood pressure, and circulation.

11. Warning Sign

Included with this spa is a warning sign. It is extremely important that this sign be permanently placed in clear view of any persons using the spa. Occasional spa users may not be aware of some of the dangers hot water poses to pregnant women, small children, and people under the influence of alcohol, drugs or medication. If you did not receive a warning sign or your sign has become damaged, please contact your spa dealer and ask for sign number PL601035 Rev A.

SAVE THESE INSTRUCTIONS

IMPORTANT SAFETY PRECAUTIONS

Your spa can be a source of great pleasure. It offers healthful stimulating recreation and is a delightful fun center for you, your family and friends. However, it contains large quantities of water and is deep enough to present inherent dangers to life and health unless the following safety rules are strictly observed.

1. Never permit the spa to be used unless it is attended by at least one person other than the bather.

Someone should be present to lend assistance if the bather should be in trouble due to injuries, cramps, drowning especially in case of children, etc.

2. Always use care in and around your spa.

The spa has many rigid, unyielding parts and many areas that become wet and slippery; these are all potentially dangerous when rough play is permitted or if care is not used particularly when entering or leaving the spa.

3. Keep the water sanitary and healthful at all times.

Your filter system will remove suspended particles from the water. Regular application of spa chemicals in proper quantities will destroy harmful bacteria and prevent formation of algae. Your surface skimmer will remove insects, leaves, and other debris from the water surface. Unsanitary water is a serious health hazard.

4. The water in your spa should NOT be warmer than 100° - 104° F (38°-40°C).

Always keep an accurate thermometer in the water because your spa's thermostat may be in error. Use a high quality, shatterproof thermometer with increments of one degree or less.

The National Spa and Pool Institute considers a temperature of 100°F (38°C) safe and comfortable for a healthy adult. Most healthy adults can enjoy this water temperature for as long as desired, although it may raise the body temperature to the water temperature and eventually become uncomfortable (like a fever). At higher water temperatures the soaking time should be shorter; never soak for more than 20 minutes when the water temperature is 102°F (39°C) or higher. If you are planning a long rest in the spa, lower the water temperature closer to normal body temperature, about 99°F (37.2°C). Some people find even lower water temperatures relaxing and pleasing. Try different water temperatures in the 98°-102°F (36.6°-39°C) range until you find what temperatures suit you best.

5. Hot water can raise the body temperature high enough to cause heat stroke.

This can be fatal even to healthy adults. If you have any questions about your own fitness or whether you should soak in the spa, check with your physician.

6. Prolonged immersion in hot water may induce hyperthermia.

Hyperthermia occurs when internal body temperature reaches a level several degrees above the normal body temperature of 98.6°F (36.6°C). The symptoms of hyperthermia include: (1) dizziness, (2) fainting, (3) drowsiness, (4) lethargy, (5) increases in the internal body temperature. The effects of hyperthermia include: (1) unawareness of impending hazard, (2) failure to perceive heat, (3) failure to recognize the need to exit spa, (4) physical inability to exit spa, (5) unconsciousness resulting in danger of drowning.

7. WARNING-The use of alcohol, drugs, or medication can greatly increase the risk of fatal hyperthermia in hot tubs or spas.

Despite the popular image of people in spas drinking wine or other alcoholic beverages, DO NOT use alcoholic beverages before or during spa use. Alcohol is a depressant which causes slowed reflexes and drowsiness, especially in conjunction with the relaxed soaking in hot water. This can lead to sleep or unconsciousness and possibly result in drowning. Using your spa with other people who are also drinking is not a preventative measure since they are likely to become similarly affected by the combinations of alcohol and hot water soaking.

Soaking in hot water causes changes in the circulatory system, such as enlargement of blood vessels near the skin. Therefore, people with a medical history of heart disease, circulatory problems, diabetes, high or low blood pressure should check with their physician before using spas. Additionally, people taking medications causing drowsiness, such as tranquilizers, narcotics, antihistamines, or anticoagulants should not use spas without asking their physician.

8. Broken or missing drain covers should be replaced immediately.

Accidents can occur when long hair or a body part is trapped by suction from a drain or outlet whose cover is broken or removed. Children are particularly vulnerable, and they should be warned against danger.

DO NOT :

Do not use electrical appliances in or around your spa. Do not use glass or other breakable items in or around your spa. Do not remove spa cabinet panels and attempt to make repairs. Do not attempt electrical repairs. Retain a certified licensed electrician.

SAVE THESE INSTRUCTIONS

Selecting A Good Location

Site Selection...

Your new spa will provide you and yours with hour upon hour of healthy, relaxing enjoyment. The following suggestions and recommendations will help you select a safe and compatible site for your spa, maximizing your enjoyment.

READ ALL SAFETY INSTRUCTIONS!

See pages 1 and 2 for other safety requirements and instructions

1. Certified Licensed Electrician Required

Electrical installation, (approval of and connection to power source) must be completed by a qualified certified licensed electrician in compliance with all codes.

2. No Overhead Power Lines

Do not locate your spa under overhead power lines or in near proximity to existing buried or exposed electrical circuits. See your electrician.

3. Childproof Your Spa

Plan for limiting access of children. Precautions such as self closing and locking gates or access doors, fencing and other child barriers, as dictated by the site.

4. UL Safety Cover Required

In addition to its insulating factors, a good cover also provides a measure of additional protection from unwanted access. Select a cover which is classified by the Underwriters Laboratories meeting ASTM F1346-91 requirements.

LEVEL, FLAT & SOLID LOAD BEARING SITE CRITICAL

DO NOT LOCATE ON A SURFACE THAT CAN BE DAMAGED BY WATER

Solid Load Bearing Site

The site must provide a solid foundation with a minimum load bearing capacity of 75 pounds per square foot (33.75 kg per 929.03 sq. cm). Concrete slabs and decks must be designed to support this weight. Do not select a site composed of individual unsupported bricks, blocks or other materials which will shift unevenly and cause damage to your spas internal frame.

Level Site, Flat Surface

A level site is critical to both the performance and enjoyment of your spa. Water is unforgiving and will always settle level. A flat and level site provides the surface necessary to properly dispense weight between the footwell which bears most of the spa's weight and the structural frame which primarily provides stabilization and secondary support. The importance of proper support for the footwell in conjunction with the spa cabinet can not be over stressed.

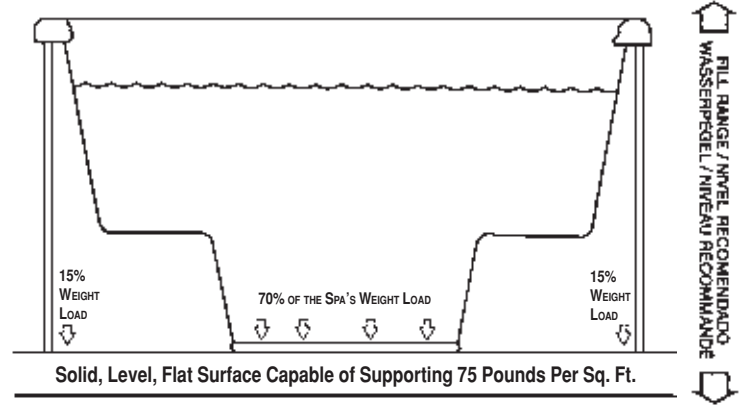

FILLING YOUR SPA

Make sure that the electrical cord has been routed properly. (See page 5 and 9).

Do not supply electrical power at this point.

1. Check to be sure that the drain valve is closed and that the drain safety cap is securely in place. (See page 5 and 9)
2. Remove filter cartridge and place garden hose end through opening (inside filter area), fill the spa with cold (never warm or hot) water 6" to 8" (150 to 200 mm) below the top edge of the spa. Do not overfill as the spa's water level will rise as each person enters the spa.
3. Always keep the spa water level above the jet openings.

THE BULK OF YOUR SPA'S WEIGHT IS SUPPORTED BY THE FOOTWELL
Failure to provide support will result in damage to the spa's shell and will void the shell warranty!

X-SPA



X-CAL



WARNING: DO NOT SUPPLY POWER TO AN EMPTY SPA!

LOCATION OF ELECTRICAL CORD & DRAIN FOR X-SPA AND X-CAL SERIES

The spa equipment requires a 15 amp outlet, dedicated to the spa. **The use of any extension cord will void your warranty.** Carefully read all of the safety requirements before plugging in the spa.



Remove and save access panel screws. Use caution when reinstalling the screws. Do not overtighten.



Open access panel.



Find power cord with G.F.C.I. and inspect the full length of the cord for any damage before each use.



Route G.F.C.I. power cord underneath the spa through the cord channel molded in the front bottom access corner hole. See next picture.

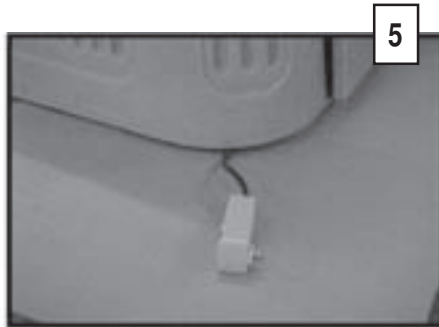

G.F.C.I. power cord routed through front left corner access hole. For illustration purposes, in this photo the cord has not been fully pulled out. In all actual installations, the power cord should be fully pulled out to facilitate clearances from hazards.



The spa drain valve assembly consists of a flexible drain pipe, shut off valve and safety drain cap and is located in the equipment compartment.

EACH TIME BEFORE FILLING THE SPA

1. Open access panel. (see picture #1)
2. Pull out the drain pipe. (see picture #6)
3. Check to be sure that the shut off valve is closed (handle perpendicular to the drain pipe).
4. Safety cap is securely in place.

TO DRAIN THE SPA

1. Unplug the electrical power cord. Do not supply electrical power again until spa is refilled.
2. Open access panel. (see picture #1)
3. Pull out the drain pipe.
4. Remove safety cap.
5. Attach a standard garden hose to the threaded safety cap nipple.
6. Place the other end of the garden hose in a drain area.
7. Open the shut off valve and monitor the draining.

CAUTION: Drain waste water may contain chemical residue and unsanitary contaminants which could be a hazard to health or the environment. Drain to specified sanitary sewer only.

SYSTEM OPERATION X-SPA and X-CAL

The spa is equipped with massage jets, an anti-vortex main drain and an automatic skim filter.



ADJUSTING MASSAGE JETS

The massage jets may be adjusted for both volume and direction.

To adjust the jet for direction simply rotate the jet's eyeball fitting in the direction desired.

To adjust the jets flow rate, rotate the jet's outer faceplate about a 1/4 of a turn counterclockwise

to increase the flow or clockwise to decrease the flow. (DO NOT FORCE)



SUCTION FITTING

Keeping the suction fitting clean and clear of all obstructions is critical in order to have a safe operation of the spa. See the safety rules for details.



SURFACE SKIM FILTER

The spa's automatic surface skim filter is designed to remove floating debris and contaminants such as body lotions by drawing water through a specially formulated filter cartridge element. It is critical that this element be routinely cleaned.

To Clean the Cartridge:

1. Shut off pump.
2. Lift the filter well cover lid.
3. Pull up the cartridge.
4. Remove the cartridge element and thoroughly rinse with a garden hose in clear water until element is free from dirt and debris.
5. Return the cartridge to the filter well and secure by pushing it in until is seated all the way down.



AIR VENTURI ADJUSTMENT

Air injection into the massage jet water flow may be controlled by manipulation of the venturi dials located on either side of the spa.

Each dial is independent and controls up to 5 jets respectively.

ECLIPSE



TRIDENT / FANTASY



GALAXY / ODYSSEY



X-100 / ESCAPE / X-TREME



X-400



X-500



WARNING: DO NOT SUPPLY POWER TO AN EMPTY SPA!

LOCATION OF ELECTRICAL CORD & DRAIN

The spa equipment requires a 15 amp outlet, dedicated to the spa. **The use of any extension cord will void your warranty.** Carefully read all of the safety requirements before plugging in the spa.



Find G.F.C.I. power plug located below the right corner of the equipment access door and cut the white tie.



Pull G.F.C.I. along with power cord and inspect the full length of the cord for any damage before each use. If cord gets tangled, remove equipment access door. (see next picture)



Remove & save access panel screws. Use caution when reinstalling the screws. Do not overtighten.

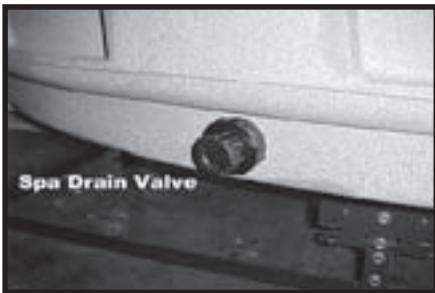

Figure 1

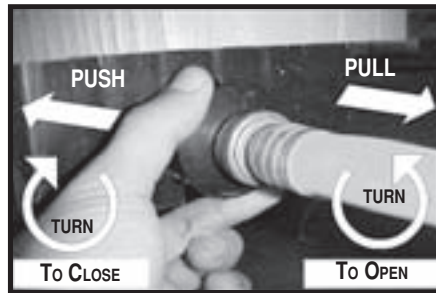

Figure 2



Figure 3

The spa drain valve assembly consists of a garden hose connector with a twist on/off valve and a safety drain cap. It is located outside at the bottom of the spa.

EACH TIME BEFORE FILLING THE SPA

1. Check to be sure that the shut off valve is closed (turn handle clockwise until it stops).
2. Safety cap is securely in place.
3. If the drain valve is facing a wall, leave enough space between valve and wall (6" minimum) in order to have enough space to connect a garden hose.

TO DRAIN THE SPA

1. Turn Power Off

Turn power off at the spa consoles and deactivate disconnect switches at the G.F.C.I. plug or load center.

2. Locate Spa Drain Valve

Located outside at the bottom of the spa. See figures 1, 2 and 3 for reference.

Drain Every Three Months

Draining your spa on a regular basis rids the spa of dissolved solids and protects your spa equipment from the effects of residual calcium hardness and total alkalinity problems.

3. Remove Drain Valve Safety Cap

Remove safety drain cap (see figure 1) and store for use when refilling your spa. Attach a standard garden hose to the drain valve.

4. Attach Hose & Select Safe Suitable Drain

Route the hose to a sewer drain capable of safely assimilating 300 plus gallons of water which may contain both unsanitary contaminants and chemical residue. To open drain valve twist counter clockwise and pull (see figure 2).

CAUTION: Drain waste water may contain chemical residue and unsanitary contaminants which could be a hazard to health or the environment. Drain to specified sanitary sewer only.



Equipment System Operation

Initial Start-Up

From the moment your spa is plug in, it is automatically pre-set to operate until it reaches 100°F. This process could take up to 20 hours depending on the initial water temperature. The spa is also pre-set to filter the water for 1 hour per day (30) and the clock starts the second you plug it in.

Temperature Adjustment 60°F-104°F

When either of the "Accu temp pads" (▲ ▼) are pressed once, the LCD will display the temperature which has been set. Each time either one of these pads are pressed again, the temperature will change by 1°F. After 5 seconds, the LCD will automatically display the current spa temperature.

Jets

Press the (⊗) pad to run the pump on and off. If left running, the pump will automatically turn off after 15 minutes.

Light

Press the (☀) pad to turn the spa light on and off. If left on, the light will automatically turn off after 4 hours.

Spa Water Maintenance

This function enables you to program the amount of water filtration time.

Press (▲) or (▼) and then (⊗) to enter the programing mode.

Once in the programing mode press (▲) or (▼) to select the filtration time.

□□ In this mode there is no additional filtration.

30 In this mode the water will be filtered for 1 hour every day.

60 In this mode the water will be filtered for 2 hours every day.

To exit press (⊗)

Standby Mode

This function allows you to disable the equipment when the filter needs to be serviced without disturbing the already programed filtration time.

Press (▲) or (▼) and then (☀) to enter the standby mode. All spa functions are disabled except for freeze control. To exit from standby press any button.



Display Messages

OH "Overheat" (spa is deactivated)

DO NOT ENTER THE WATER. If the spa water has reached 108°F (44°C), Remove the spa cover to cool the water. The spa will remain shut down until the water and the heater sensor cools to 104°F. At that point press any button to reset the spa. If the spa will not reset, shut off the power to the spa and call your dealer or service organization.

SN "Non Functional High Temp Sensor" (heater is deactivated)

Open sensor. Call your dealer or service center.

WARNING

**OPERATING THE SYSTEM WITHOUT WATER
WILL CAUSE SEVERE DAMAGE**

**OPERATING THE SYSTEM WITH
ANY TYPE OF EXTENSION CORD
WILL CAUSE SEVERE DAMAGE**

WARNING: SHOCK HAZARD! NO USER SERVICEABLE PARTS. Do not attempt to service this control. Contact your dealer or service center for assistance. Follow all owner's manual power connection instructions. Installation must be performed by a certified licensed electrician and all grounding connections must be properly installed.

The spa is equipped with massage jets, two anti-vortex main drains and an automatic skim filter.



ADJUSTING MASSAGE JETS

The massage jets may be adjusted for both volume and direction.

To adjust the jet for direction simply rotate the jet's eyeball fitting in the direction desired.

To adjust the jet's flow rate, rotate the jet's outer faceplate about 1/4 turn counterclockwise to increase the flow or clockwise to decrease the flow. (DO NOT FORCE)

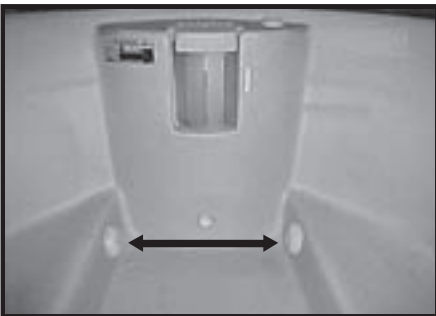

SUCTION FITTINGS

Keeping the suction fitting covers clean and clear of all obstructions is critical in order to have a safe operation of the spa. See the safety instructions rules for details.(page 1)



SURFACE SKIM FILTER

The spa's automatic surface skim filter is designed to remove floating debris and contaminants such as body lotions by drawing water through a specially formulated filter cartridge element. It is critical that this element be routinely cleaned.



To Clean the Cartridge:

1. Place system on Lockout Mode or disconnect power.
2. Remove the filter cover.
3. Turn cartridge counterclockwise and pull up.
4. Remove the cartridge element and thoroughly rinse with a garden hose until element is free from dirt and debris.
5. Return the cartridge to the filter well by following steps 1 - 4 in reverse order.



AIR INJECTION VENTURI ADJUSTMENT

Air injection into the massage jet water flow may be controlled by manipulation of the venturi dials located on either side of the spa. Each dial is independent and controls up to 5 jets respectively.

SPA OPERATION / WATER CHEMISTRY

Spa water chemistry (or water balance) affects the safety of your equipment as well as the appearance of your spa water. Water balance has five factors: pH, total alkalinity, calcium hardness, temperature and total dissolved solids. pH is the most critical but total alkalinity and calcium hardness must also be watched closely. Low calcium hardness can lead to corrosion of equipment, while high calcium hardness can lead to scaling, cloudy water and staining. Water temperature should never exceed 104°F (40°C), and total dissolved solids should be kept below 1500 PPM.

Algicidal and sanitizing chemicals are either alkaline or acid. Sodium and calcium hypochlorites are alkaline. Chlorine gas and practically all other dry chlorine spa products are acid. On the market are a number of bromine sanitizers. Bromines are usually preferred since they don't emit a strong chlorine odor.

SEE YOUR SPA WATER EXPERT FOR ADDITIONAL INFORMATION

USE OF CALCIUM HYPOCHLORITES OR TRICHLORS WILL VOID WARRANTY

1. Check and adjust water conditions. You must maintain proper chemical balance to insure safe sanitary conditions and to prevent your spa from becoming a breeding place for bacteria. This is done by:
 - A. Test daily and maintain pH between 7.2 and 7.8. Adjust if necessary, above 7.8 use pH decrease, if below 7.2 use pH Increase. Improper pH can damage spa finish, equipment, cause eye irritation and chemical loss. Use dosage according to manufacturer's label.
 - B. Test alkalinity and maintain at 80 ppm to 140 ppm. Adjust if necessary, above 140 ppm use pH Decrease, if below 80 ppm use Total Alkalinity Control. Use dosage according to manufacturer's label.
 - C. Test daily and maintain proper sanitizer level. It's recommended to use bromine sanitizer and maintain bromine at 3.0 - 5.0 ppm. Typically two or three bathers relaxing in an average spa with 103°F (39.4°C) temperature will consume all the bromine sanitizer in about twenty minutes. Therefore, prolonged or heavy use may require additional bromine to maintain safe sanitary conditions.
 - D. "Shock" (with a non-chlorine shock) once a week and after each water change. Do not use spa until the bromine residual has dropped to less than 5.0 ppm. NOTE: Improper pH will cause early corrosion to your pump. Corrosion is not handled under any warranty.

SPA MAINTENANCE SCHEDULE

DAILY

Test and maintain pH: Ideal range 7.2 - 7.8

Test and maintain bromine: Ideal range 3.0 - 5.0 ppm

WEEKLY

Test and maintain alkalinity 80 - 140 ppm

"Shock" with a non-chlorine shock

Add Spa Clear

MAINTENANCE

Add defoamer as needed

Inspect filter cartridge every 2 weeks and clean when needed



SPA OPERATION / WATER CHEMISTRY continued

2. It is recommended that the spa be drained regularly depending on its size, location and the frequency of use.
3. Clean filter and cartridge periodically according to manufacturer's instructions.
4. Keep the spa covered when not in use to reduce the loss of heat and to keep our leaves, dirt, and other foreign materials from settling in the water.
5. Since the water capacity of your spa is far less than that of a swimming pool, the chemical reaction caused by the presence of one or more persons in the spa is more rapid and pronounced. For these reasons, it is important to frequently check the bromine level, the pH level and total alkalinity of water then add the prescribed chemicals as necessary to maintain the proper chemical balances.
6. If questions or doubts arise regarding quantities and timing or chemical applications to your spa, contact your spa dealer who can assist you in prescribing the correct program for your spa.
7. Store all chemicals in a cool dry place and in such a manner as to prevent contact by children and pets.
8. When adding chemicals to your spa water, add to the center of the spa with the pump operating. Never add chemicals to unheated water as this will affect chemical action.

CHEMICAL NOTES

DreamMaker^{SPAS}

Live the dream

FREEZE PROTECTION

DO NOT ALLOW THE SPA TO FREEZE

If the spa is to be stored or transported in temperatures 32°F (0°C) or lower, it is critical that the unit be fully winterized.

1. The spa itself must be completely emptied.
2. The main drain valve must be in the open position.
3. The drain safety cap must be removed and stored.
4. Remove the pump wet end drain plug.
5. The filter cartridge element must be removed, dried and stored.
6. The massage jet faces must be removed and stored.
7. The spa must be inverted for at least five minutes to facilitate draining of the internal plumbing.

CLEANING THE SPA

Do not use cleaners or compounds containing harsh abrasives. Also, avoid using heavy-duty rubbing or buffing compounds. Use a soft liquid cleaner.

CARE OF DELUXE VINYL HARDCOVER

Vinyl coated fabrics are perhaps the most maintenance-free fabrics ever produced and certainly will provide exceptional service life if given the proper care. Almost all vinyl manufacturers now provide information concerning the necessary cleaning procedures for their products. In reality, all care maintenance instructions are the same for all coated fabrics regardless of their manufacturing origin.

Products are now on the market that are manufactured to enhance the beauty and service life of all vinyls. However, by using methods described below with minimal care and attention, you should enjoy years of satisfaction and pride with any vinyl coated fabric.

EVERYDAY SOIL

A gentle mixture of any mild soap and warm water will generally dissipate most common soil from the surface. Using a soft cloth, wash the area to be cleaned and rinse. If stubborn dirt remains, as a stain embedded in the grain of the vinyl, use a soft brush, and if necessary, a touch of cleaning powder. In both situations, rinse and dry with a soft cloth.

Most Frequently Asked Questions

1. Why does my spa not shut off?

The Dream Maker Spa is designed to run from the time you plug it in to run until it reaches your desired temperature. Once desired temperature is reached then you can control the on/off with the buttons on the top control. **For example: On the initial startup the spa will run for approximately 18 hours to reach 100 degrees. At that point the spa will shut off, then the spa will maintain your desired temperature settings. Keep in mind that anytime power is disrupted from the spa, the spa will reset itself and run until it reaches the spa's default settings.**

2. Why does my spa turn on late at night?

The spa is designed to filtrate every 12 hours. The clock starts the second you plug it in. Recommend unplugging and plugging back in between 7 and 8. This means the spa will come on every 12 hours at the designated time and filtrate the amount of time you have it set for.

3. Why is my spa hotter than it is set for?

If your spa is set for 101 degrees but it reads 103 degrees most likely your filter cycle is set too high. Adjust your filter cycle down to the next lower setting or **F0**. Remember, when the spa is running to filtrate it is also heating.

4. Why is my spa not heating?

All Dream Maker Spas heat at approximately 1.5 degrees per hour. If your water temperature is 70 degrees when you first fill your spa it will take approx. 20 hours to reach 100 degrees. **Remember, it is imperative to keep your safety cover on and the air control valves turned off while heating.**

5. One of the jets won't work. What do I do?

First of all, all the jets on Dream Maker Spas are individually controlled. If a jet is not producing the venturi turn the jet face counter clockwise and open up the air control knob. The jets are designed individually so you can control the pressure at each jet.

6. What is the tool included in the Owners Manual Kit for?

The tool located with the filter and manual package is a jet wrench for maintenance. We suggest twice a year you remove the jet face with the flat head screwdriver, insert the jet wrench tool and tighten the jet 1/8 to 1/4 turn clockwise. (See page 17 for detail instructions)

7. How do I change the light bulb?

For the top light there is an access panel located on the outside wall of the spa, directly behind the light.
For the bottom light, first drain the spa, tilt up, and you can easily reach in and give the bulb housing a quarter turn counter clockwise to take out the bulb. To install, follow the same steps in reverse order.

8. How many gallons does my spa hold?

Eclipse	= 210 gallons	X-100 / Escape /	X-500	= 270 gallons
X-Spa-Dition	= 200 gallons	X-Treme	Odyssey / Galaxy	= 260 gallons
X-400	= 200 gallons	X-Calibur	Trident / Fantasy	= 260 gallons
Trident / Fantasy	= 200 gallons			

9. I see water on the floor. What does this mean?

The cover can accumulate condensation between the seams and run down the sides of the spa. You can verify that water is coming from the cover by squeezing the seam, or by repositioning the cover so that the seam is on a different side. This only occurs when the temperature and humidity are at certain levels.

10. What do I do if I cannot fix a problem?

Contact the dealer from whom you purchased the spa or contact our customer service at Dream Maker Spas 888-ROTO-SPA.

Troubleshooting Guide

NO HEAT OR HEAT TOO LOW

PROBABLE CAUSE #1 Operating while spa cover is open.
ACTION Ensure that spa cover is properly closed.

PROBABLE CAUSE #2# Dirty filter
ACTION Remove filter cartridge and clean.

PROBABLE CAUSE #3 Adjustable jets closed or not fully opened.
ACTION Open all jets.

JETS WON'T COME ON

PROBABLE CAUSE #1 No power to spa control.
ACTION Check incoming power to spa.

PROBABLE CAUSE #2# Pump disconnected from control box.
ACTION Call dealer for recommended action.

PROBABLE CAUSE #3 Faulty pump or top control panel.
ACTION Call dealer for recommended action.

NO CONTROL DISPLAY OR FUNCTIONS

PROBABLE CAUSE #1 No power or improper voltage to spa control.
ACTION Have a licensed electrician check the voltage to spa.

PROBABLE CAUSE #2# Control box fuse blown.
ACTION Call dealer for recommended action.

PROBABLE CAUSE #3 Faulty top control panel.
ACTION Call dealer for recommended action.

LOW WATER FLOW

PROBABLE CAUSE #1 Dirty filter.
ACTION Remove filter cartridge and clean.

PROBABLE CAUSE #2 Jets not fully opened.
ACTION Open all jets.

PROBABLE CAUSE #3 Low water level.
ACTION Make sure water level in spa is correct.

NO AIR BUBBLES IN JET

PROBABLE CAUSE #1 Air control valve in the closed position.
ACTION Open air control valve. See page 7 or 11

PROBABLE CAUSE #2 Jet (s) in the closed position.
ACTION Open jet (s). See page 7 or 11

PROBABLE CAUSE #3 Faulty jet internal valve.
ACTION Call dealer for recommended action.

SPA IS LEAKING

PROBABLE CAUSE #1 Spa drain valve and cap partially open.
ACTION Ensure that drain valve and cap are fully closed.

PROBABLE CAUSE #2 Loose jet wall fitting.
ACTION See jet wrench instructions page.

PROBABLE CAUSE #3 Loose pump union (s).
ACTION Call dealer for recommended action.

NO SPA LIGHT

PROBABLE CAUSE #1 Burned out bulb.
ACTION Replace bulb (see page 17)

PROBABLE CAUSE #2 Light fuse blown.
ACTION Call dealer for recommended action.

PROBABLE CAUSE #3 Light harness unplugged from control box.
ACTION Call dealer for recommended action.

SLOW WATER DRAIN

PROBABLE CAUSE #1 Drain valve not fully opened.
ACTION Ensure that valve is fully open. See page 4 or 8.

PROBABLE CAUSE #2 Dirty filter or suction drain cover grate.
ACTION Remove filter cartridge or clean cover grate.

PROBABLE CAUSE #3 Kinked garden hose
ACTION Make sure that drain hose is fully extended and placed in a flat or downhill position

Jet Wrench Tool Instructions and Recommended Use

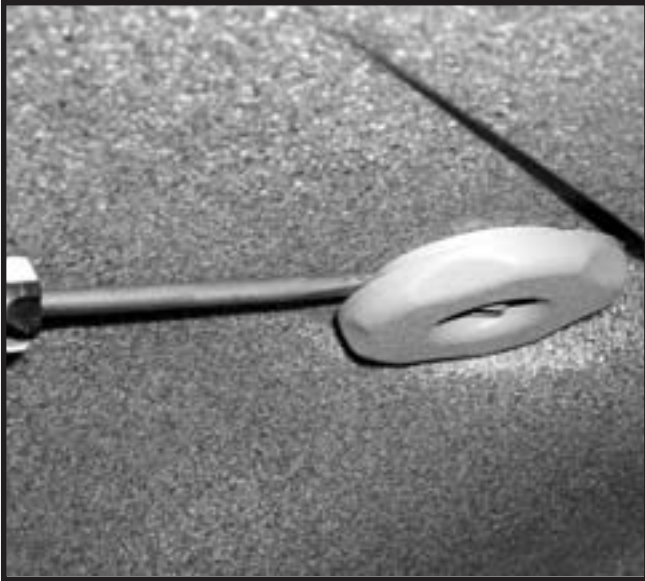

1. Insert a flat screwdriver between the jet face and the spa shell. Twist the screwdriver to pop the jet face.



2. Insert the long part of the jet wrench and turn counter clock wise until there is no tension.



3. Remove jet wrench and jet internal nozzle assy. Inspect condition and lubricate O-rings as needed.



4. It is recommended to check and re-adjust the jet wall fitting using the short end of the jet wrench at least twice per year.

Glossary of Terms

AIR CONTROL VALVE

Mounted on the lip of the spa or at the equipment shroud, to induce air to the jets.

CHECK VALVE

Prevents back flow of water through system.

CONTROL BOX

Basically the brain of the spa. Power is distributed to all functions of the spa, pumps, lights, heat, etc.

DRAIN VALVE

Used in the draining of the spa, looks like an outdoor faucet and fits a standard garden hose.

FILTER

The filter cleans the spa and removes particles and debris and protects the equipment from foreign substances.

FOOTWELL

The bottom of a spa where you place your feet.

G.F.C.I. BREAKER

The electronic switch installed in the power cord to give power to the spa.

HEATER

The thermostatically controlled heater raises the temperature of the water to the desired degree. This is located under the control box in the equipment area.

JETS

The fittings on your spa that direct the flow of water for massaging action.

pH

Stands for "Potential for Hydrogen" This is the term used to describe the acid (low pH) or alkalinity (high pH) condition of the water. The ideal pH for spa water is 7.5.

SKIMMER

The skimmer removes surface debris to the filter. The water level in the spa should be kept at the proper range for optimum skimmer operation.

SUCTION DRAIN

The fitting set into the footwell that drains water from the spa.

TOP CONTROL PANEL

Mounted on the lip of the spa. The digital panel that controls the spas functions.

[illegible]

Please help us serve you better in the future by completing the following:

	Yes	No		
Are you satisfied with the features of the product?	<input type="checkbox"/>	<input type="checkbox"/>		
Are you happy with the quality of the product?	<input type="checkbox"/>	<input type="checkbox"/>		
Have you been contacted to make sure you are satisfied?	<input type="checkbox"/>	<input type="checkbox"/>		
Have you required any service since installation?	<input type="checkbox"/>	<input type="checkbox"/>		
Would you recommend the dealer or store to a friend?	<input type="checkbox"/>	<input type="checkbox"/>		
Was your salesperson well informed about the product?	<input type="checkbox"/>	<input type="checkbox"/>		
Was the product delivered when promised?	<input type="checkbox"/>	<input type="checkbox"/>		
Was the product installed quickly and professionally?	<input type="checkbox"/>	<input type="checkbox"/>		
Overall, have you had a good experience with the dealer?	<input type="checkbox"/>	<input type="checkbox"/>		
<i>What prompted your purchase from this particular dealer or store? (check all that apply)</i>				
Display <input type="checkbox"/>	Advertising <input type="checkbox"/>	Product Knowledge <input type="checkbox"/>	Referral <input type="checkbox"/>	Price <input type="checkbox"/>
<i>Why did you buy the spa? (check all that apply)</i>				
Recreation <input type="checkbox"/>	Health/Therapy <input type="checkbox"/>	Home Improvement <input type="checkbox"/>		
<i>Why did you choose this spa? (check all that apply)</i>				
Quality <input type="checkbox"/>	Value <input type="checkbox"/>	Size <input type="checkbox"/>	Design/Seating <input type="checkbox"/>	Special Features <input type="checkbox"/>
<i>Where did you have it placed?</i>				
Deck or Patio <input type="checkbox"/>	Screen Room <input type="checkbox"/>	Inside House <input type="checkbox"/>	Elsewhere <input type="checkbox"/>	
<i>Do you own any of the following? (check all that apply)</i>				
Above-Ground Pool <input type="checkbox"/>	Billiard Table <input type="checkbox"/>	Tanning Bed <input type="checkbox"/>		

fold _____ fold
Comments _____

Thank you for taking time to help us serve you even better in the future!

WARRANTY REGISTRATION

Please complete promptly to activate your warranty

Model Number _____ Serial Number _____
Dealer or Store Name _____
City/State Where Purchased _____
Date Purchased _____ Home Phone _____
Your Name _____
Your Address _____
City, State, ZIP Code _____
E-mail Address _____

This is all the information required to promptly register your warranty.

So that we can serve you even better in the future, please take a few moments to check off answers on the top.

Postage
Required
Post Office will
not deliver
without proper
postage

DREAM MAKER SPAS
2452 LAKE EMMA RD
LAKE MARY FL 32746-6339



Fold / Seal at Top and Mail

