

**POOL FROG® Mineral Reservoir:
Patented Mineral Pool Sanitizer**

**Operational
Instructions**



**REPLACE EVERY 6 MONTHS OR
AFTER ONE POOL SEASON WHICHEVER IS SHORTER.**

POOL FROG® Mineral Reservoir: Patented Mineral Pool Sanitizer Operational Instructions

Replace every 6 months or after one pool season whichever is shorter.

Swimming Pool Tips



1. Make sure the pool has adequate circulation. The pool water must completely circulate through the pump and filter at least 1 to 2 times per day. This usually requires 8 to 12 hours. Check with your dealer for the proper circulation time for your pool.



2. Before beginning with any pool care program, you must first balance your pool water. Take a water sample to your local pool professional or use a complete test kit that will test for the following important elements.

Water Balance Guidelines

pH:	7.2 – 7.8
Total Alkalinity:	60–120 ppm
Calcium Hardness:	150-400
Total Dissolved Solids:	<1500
Stabilizer:	20–80 ppm
Free Chlorine:	0.5 – 1.0 ppm

Cu Mg Fe Fe Cu Mg

3. If your fill water is high in metals, check with your pool professional on how to maintain proper levels. It may require shocking the pool and cleaning the filter.

4. After your pool is up and running smoothly, continue to test your water for pH, total alkalinity and chlorine and maintain its balance by adding any necessary adjustment products (see your dealer for details).

5. Check the pool's filter gauge often and periodically clean filter per the manufacturer's directions. A dirty filter will slow the flow of water which could hamper proper circulation.



Replacing a POOL FROG® Mineral Reservoir, FROG BAM® and Bac Pac



1. Check the front of the box and back label of product to make sure you have the correct POOL FROG® Mineral Reservoir to fit your POOL FROG® Cyclor.

THE POOL FROG® MINERAL RESERVOIR MUST BE REPLACED EVERY 6 MONTHS OR AFTER ONE POOL SEASON WHICHEVER IS SHORTER.

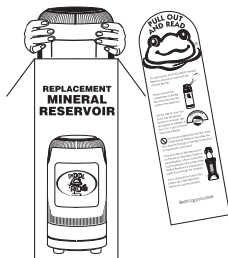

2. Open the box and remove the POOL FROG® Mineral Reservoir.

IMPORTANT: Remove and read the inserted information card.

CAUTION read carefully -

• USE ONLY the factory recommended replacement POOL FROG® Mineral Reservoir, FROG BAM® and Bac Pac. DO NOT USE any other Pac or bulk chemical tablets in the Cyclor. Use of any other product could result in damage to pool equipment or surface, unsafe pool conditions, fire or explosion. Warranty will be void if the correct POOL FROG® Mineral Reservoir, FROG BAM® and Bac Pac are not used.



3. Turn off pump and turn dial to Pac Removal or Setting 0 depending on the model.

4. Open cap. If using Bac Pac stand back to avoid inhaling chlorine fumes.

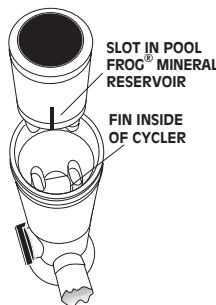

5. Find slot on side of POOL FROG® Mineral Reservoir and line up with fin inside the Cyclor. Lower POOL FROG® Mineral Reservoir into Cyclor until secure.

USING FROG BAM® FOR AN ALGAE-PROTECTION GUARANTEE

(If you are not using FROG BAM®, proceed to Step 12.)

For a preventative dose, add one FROG BAM® per 10,000 to 15,000 gallons or two FROG BAM® per 20,000 to 30,000 gallons.

See FROG BAM® product labeling for complete directions for use (EPA Reg No. 53735-9).



6. Remove cap from FROG BAM® without removing seal.

7. Insert upside down into center of POOL FROG® Mineral Reservoir pushing down firmly on key to puncture seal.



8. Replace cap by hand only. **DO NOT OVERTIGHTEN.** Turn control dial on Cyclor to Maximum or Setting 10 depending on the model.



9. Turn pump on for 90 minutes allowing FROG BAM® to circulate through pool.



10. To remove FROG BAM®, turn pump off, turn dial to Pac Removal or Setting 0 depending on the model, remove Cyclor cap.

11. Lift FROG BAM® up and allow any water in the container to drain through the Cyclor before discarding in trash.

NOTE: If water shows more than a hint of blue inside Cyclor, replace the Cyclor cap, turn dial to Maximum or Setting 10 and run the pump for one minute.

11a. If pool size requires additional FROG BAM®, repeat steps 6-11.

11b. When water is clear in Cyclor, proceed to step 12.



USING THE BAC PAC

12. Bac Pac recommended to assure up to 50% reduction in chlorine use.* Bac Pac sold separately. (EPA Reg. No. 53735-2)

**Compared to the minimum EPA recommended chlorine level of 1.0 ppm for a stabilized swimming pool*



13. Avoid sparks, open flame or smoking when handling the Bac Pac.



14. To remove Bac Pac colored caps, grab onto the lip of one cap with a pliers and pull up until cap releases. Repeat the process for the other cap.

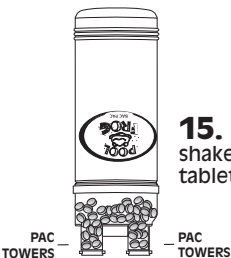
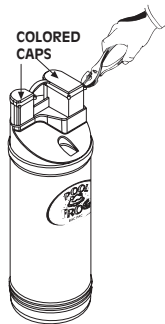

15. Turn Bac Pac over and shake slightly until chlorine tablets fall into tower areas.

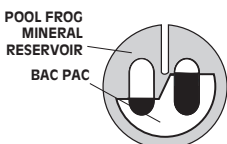

16. Line up the small leg of the Bac Pac with the small opening in the POOL FROG® Mineral Reservoir and the large leg with the large opening. Lower Bac Pac into POOL FROG® Mineral Reservoir until secure.



17. Replace cap by hand only. **DO NOT OVER TIGHTEN.**



18. Mark your calendar for the six month replacement of the POOL FROG® Mineral Reservoir, 90-day replacement of FROG BAM® and approximate replacement times for the Bac Pac. Once wetted, the time-released mineral coating of this product is effective up to 6 consecutive months or one pool season whichever is shorter. After that time, even if you hear the spent media inside, it is no longer effective and must be replaced.

Start-up and Operation



• Add a stabilizer or conditioner to the pool at the beginning of the season if the stabilizer level is below 20 ppm. This will prevent chlorine burn off. Follow manufacturer's directions carefully.



• Shock the pool with chlorine to rid the water of all contaminants before beginning. Follow manufacturer's directions carefully.

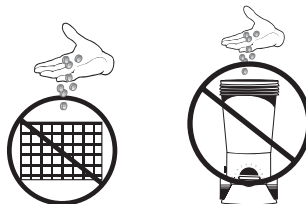

• **Do not** add shock in or near the skimmer or into the Cyclor as it could damage equipment, risk potential explosion or discolor your pool surface.

• **THIS STEP IS VERY IMPORTANT TO START-UP. USE CHLORINE SHOCK ONLY.**

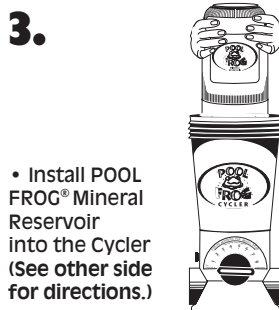

• Install POOL FROG® Mineral Reservoir into the Cyclor (See other side for directions.)

REPLACE THE POOL FROG® MINERAL RESERVOIR EVERY 6 MONTHS OR AFTER ONE POOL SEASON WHICHEVER IS SHORTER.



• Replace cap and run Cyclor, with POOL FROG® Mineral Reservoir inserted, for 10 minutes on setting Maximum or Setting 10 depending on the model.

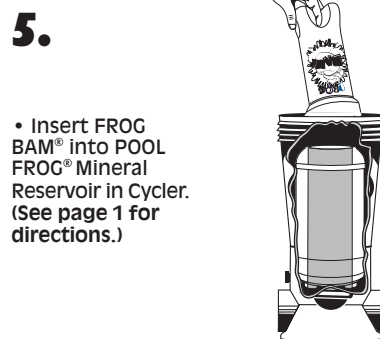

• Insert FROG BAM® into POOL FROG® Mineral Reservoir in Cyclor. (See page 1 for directions.)

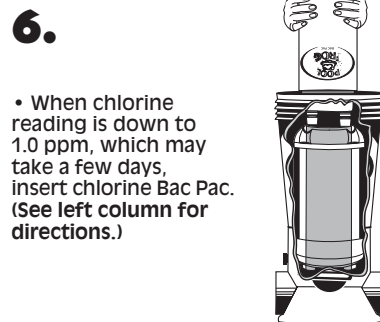

• When chlorine reading is down to 1.0 ppm, which may take a few days, insert chlorine Bac Pac. (See left column for directions.)

FOR IN GROUND MODELS

For In Ground models, cap removal is easier if using the tool included with the Cyclor. To loosen cap, hit the handle with the flat of your hand counter clockwise. **DO NOT USE CAP TOOL TO TIGHTEN CAP.**



Start-up and Operation

7. SETTING CONTROL DIAL

• Set control dial by matching up the parameters of your pool on the charts below. **THIS IS A STARTING POINT ONLY** and may need to be adjusted to fit your individual pool needs. See #8 for directions.



Above Grd. POOL SIZE		8 Hour Pump Run Time				12 Hour Pump Run Time				24 Hour Pump Run Time			
Gallons	Diameter	PUMP SIZE				PUMP SIZE				PUMP SIZE			
		1/2 hp	3/4 hp	1 hp	1 1/2 hp	1/2 hp	3/4 hp	1 hp	1 1/2 hp	1/2 hp	3/4 hp	1 hp	1 1/2 hp
7,000	(18')	5	4.5	4	3.5	4.5	4	3	* 5	3.5	3	2.5	* 4
9,000	(21')	5.5	5	4.5	4	5	4.5	4	* 5.5	4	3.5	3	* 4.5
12,000	(24')	6	5.5	5	4.5	5.5	5	4.5	4	4.5	4	3.5	* 5
15,000		NR	6	5.5	5	6	5.5	5	4.5	5	4.5	4	3.5
20,000		NR	NR	6	5.5	NR	6	5.5	5	5.5	5	4.5	4

Inground POOL SIZE		8 Hour Pump Run Time				12 Hour Pump Run Time				24 Hour Pump Run Time			
Gallons		PUMP SIZE				PUMP SIZE				PUMP SIZE			
		3/4 hp	1 hp	1 1/2 hp	2 hp	3/4 hp	1 hp	1 1/2 hp	2 hp	3/4 hp	1 hp	1 1/2 hp	2 hp
7,000		3.5	3	2.5	* 2.5	3	2.5	* 4	* 3.5	1.5	* 3.5	* 3	* 2.5
9,000		4	3.5	3	2.5	3.5	3	2.5	* 4	2.5	* 4	* 3.5	* 3
12,000		4.5	4	3.5	3	4	3.5	3	2.5	3	2.5	1.5	* 3.5
18,000		NR	4.5	4	3.5	5	4	3.5	3	3.5	3	2.5	2
25,000		NR	NR	4.5	3.5	NR	5	4	3.5	4	3.5	3	2.5
30,000		NR	NR	5.5	4.5	NR	5.5	5	4	4.5	4	3.5	3
35,000		NR	NR	6.5	5.5	NR	6.5	5.5	5	5.5	4.5	4	3.5
40,000		NR	NR	NR	6.6	NR	NR	6.5	5.5	6.5	5.5	4.5	4

* - Bypass installation recommended.

NR - This pump size is not recommended for this size pool.

Most common pool sizes

8.

• For the first week test the pool water daily for free chlorine to ensure correct dial setting. Continue to test weekly throughout the season.



After testing, adjust the dial up by 1/2 increment if the free chlorine reading has dropped below 0.5 ppm or down by 1/2 increment if the reading has risen above 1.0 ppm. Continue this process each day until the reading stabilizes to at least 0.5 ppm.

Remember to adjust dial by 1/2 increments only, in order to prevent over chlorination which may bleach pool surfaces.



9.

• Shock pool every two weeks or as needed to maintain water quality. Follow label directions on the shock treatment used.



If using another means of chlorine

Follow steps 1-5 on Start-up and Operation and then continue below.

6.

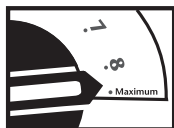

• Maintain setting of Maximum or Setting 10 depending on the model. No adjustments needed.

7.

• Maintain a minimum chlorine reading of 0.5 ppm with a chlorine delivery device or hand feeding.

8.

• Shock pool every two weeks or as needed to maintain water quality. Follow label directions on the shock treatment used.



KING TECHNOLOGY, INC.

530 11th Avenue South, Hopkins, MN 55343 U.S.A. 952-933-6118 • 800-222-0169 • FAX 952-933-2206 • www.kingtechnology.com

Covered by one or more of the following patents:
U.S. Patent Number 6,190,547; 6,210,566; 6,217,892;
6,383,507; 6,544,415; 6,551,609; 6,652,871 and other U.S.
and foreign patents pending.
EPA Est. No. 071209-AZ-001

20-48-0145
553100543R2